

(8X) 45°

(2x) Tap 1/4-20 THRU
For setscrew

--- Lathe spindle CL

NOTE:
Bore to slip-fit body of Makita
RT0701 router motor

Bottom View

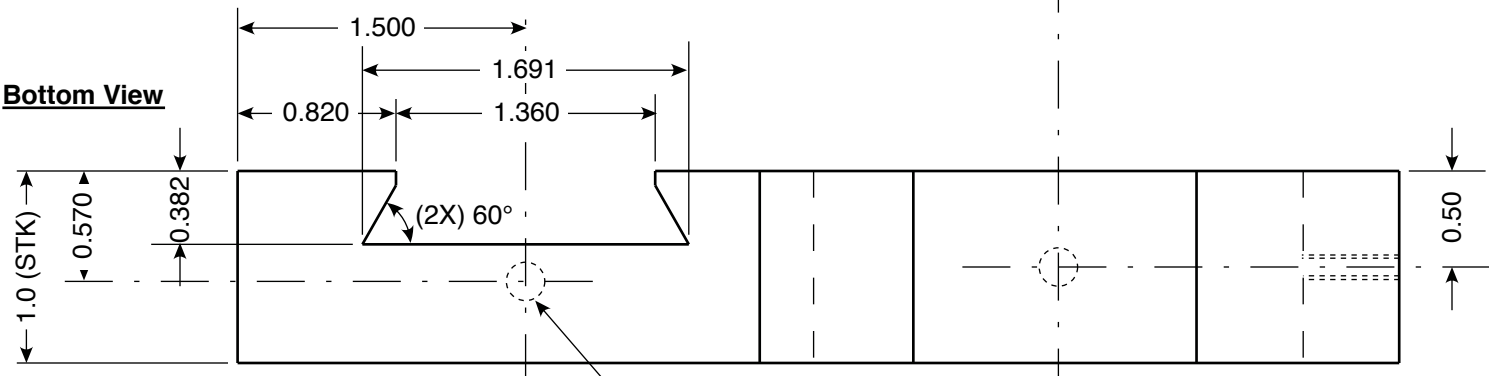

Tap 1/4-28 \downarrow .40 FAR SIDE
For height adjuster

MTL: PLATE, 6061-T6

**Toolpost Grinder Mount,
Phase II AXA Holder,
South Bend Heavy 10**
GW Johnson 8-10-22
gwj@me.com